

- > service machine for the cot maintenance workshop
- > quick and trouble-free mounting and removing of long cots
- > hydraulic operation
- > incl. Rosink tool set
- > made in Germany



# Cot Mounting RCM-H



## Application

Rosink Cot Mounting RCM-H is exclusively designed for accurate mounting and dismounting of long cots, e.g.: draw frame, comber and lapformer.

An applicable tool set is available for commonly used yarn preparation machines.

| RCM-H                     |                       |
|---------------------------|-----------------------|
| Installation height under | 1000 m above SL       |
| Width                     | 2085 mm               |
| Depth                     | 620 mm                |
| Height                    | 725 mm                |
| Weight of RCM-H approx.   | 175                   |
| Weight of toolbox approx. | 12,5                  |
| Colour scheme             | Pure white / sky blue |

| Intended use / Performance    |                      |
|-------------------------------|----------------------|
| Max. draw frame roller length | 420 mm               |
| Axle pin diameter             | Ø10, Ø12, 15 mm      |
| Cover inside diameter         | Ø16, Ø23, 26, Ø30 mm |
| Hydraulic motor unit          | 2,2 kW               |
| Set pressure hydraulic system | 130 bar              |
| Piston diameter               | Ø50 mm               |
| Rod diameter                  | Ø28 mm               |
| Theoretical pushing force     | 25.526 N             |
| Theoretical pulling force     | 17.521 N             |
| Tank volume                   | 8 liters             |
| Pump delivery capacity        | 8,5 l/min            |

| Type of power supply          |          |
|-------------------------------|----------|
| Internal voltage main circuit | 400 V AC |
| Control voltage               | 24 V DC  |
| Frequency                     | 50 Hz    |
| Nominal power consumption     | 2,2 kW   |

| Emissions      |            |
|----------------|------------|
| Noise emission | <70 dB (A) |

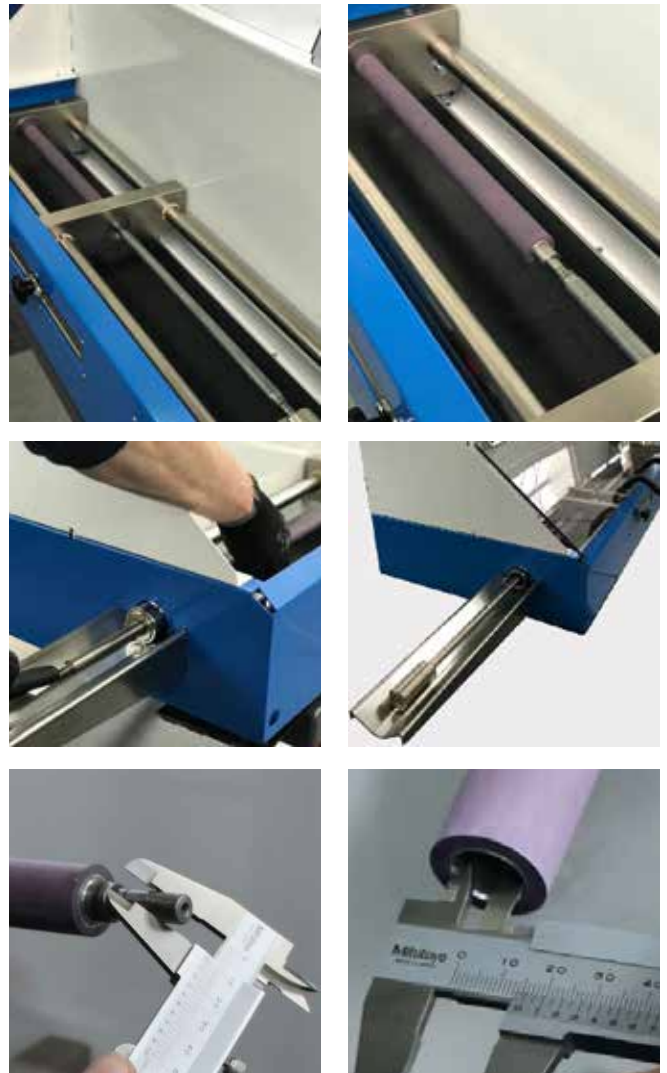

## Standard Tool Set:

